

BAMBU STRUCTURE

gaviota
Sun Life Specialist

Structure of fixed awning with tensed fabric

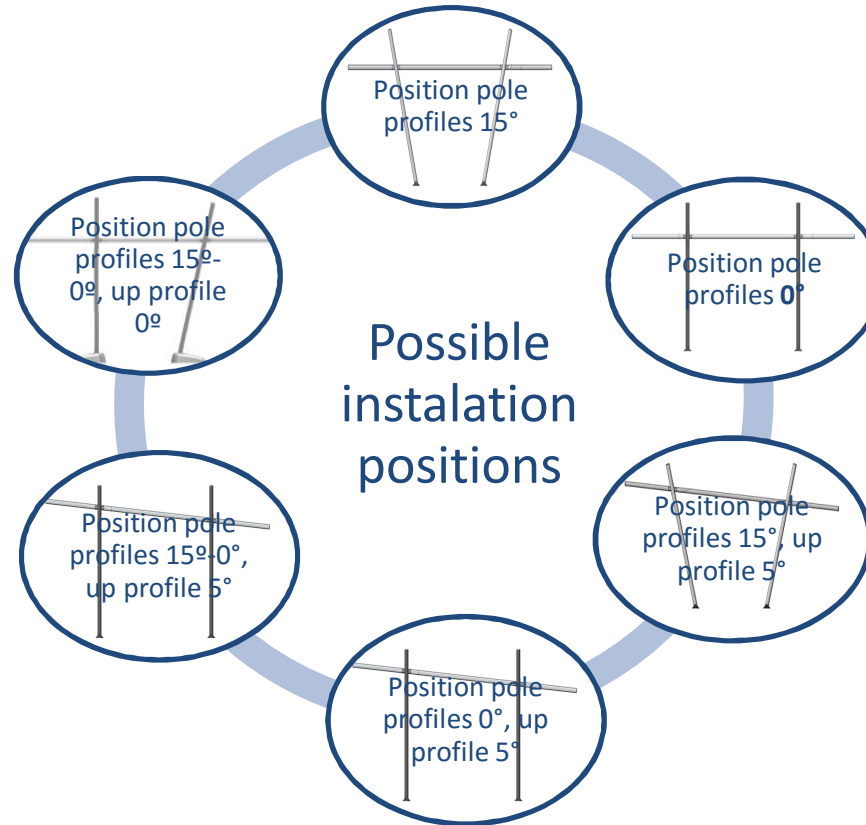



BAMBU

gaviota
Sun Life Specialist

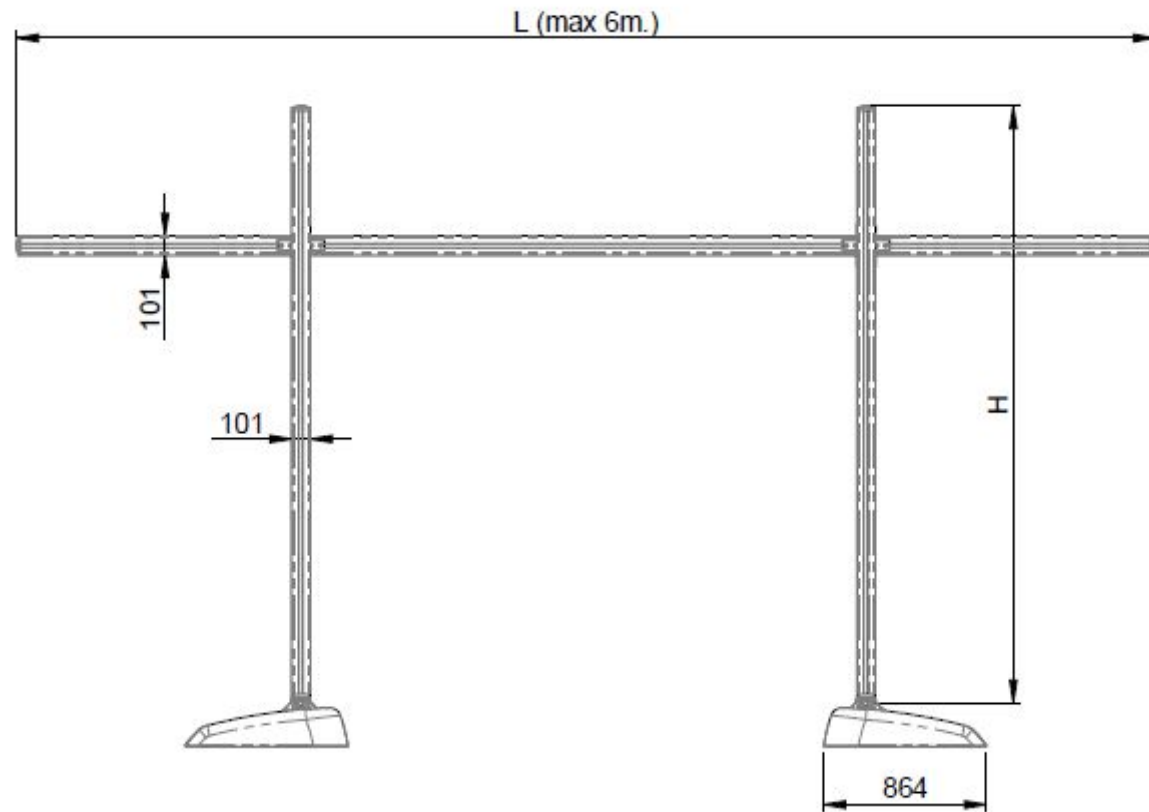
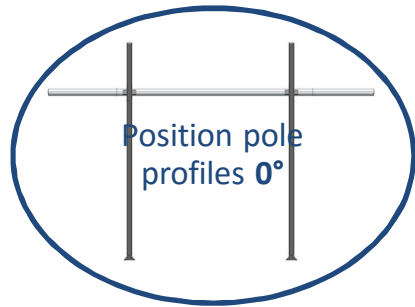

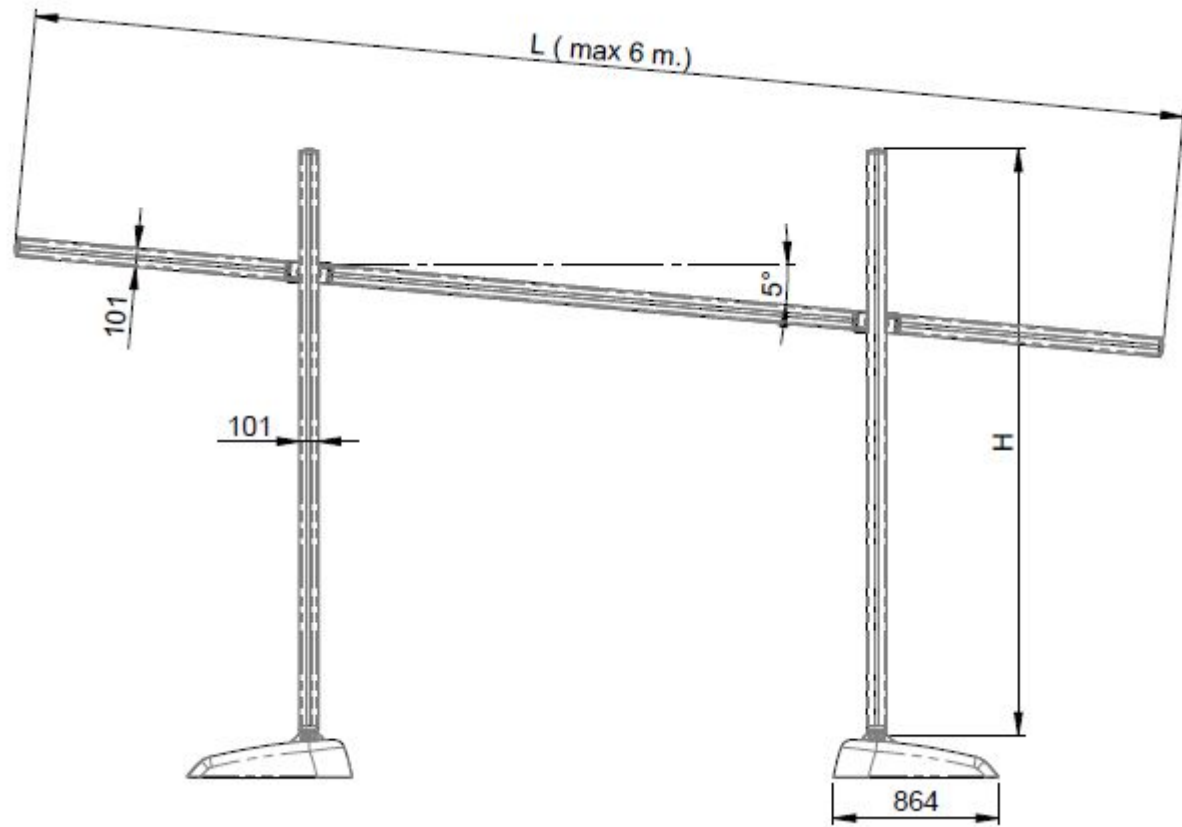
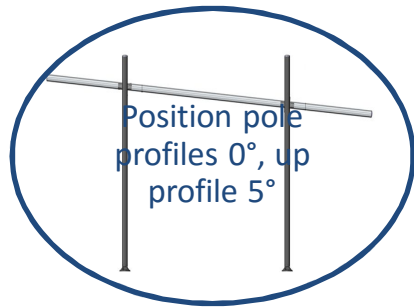

BAMBU

gaviota
Sun Life Specialist

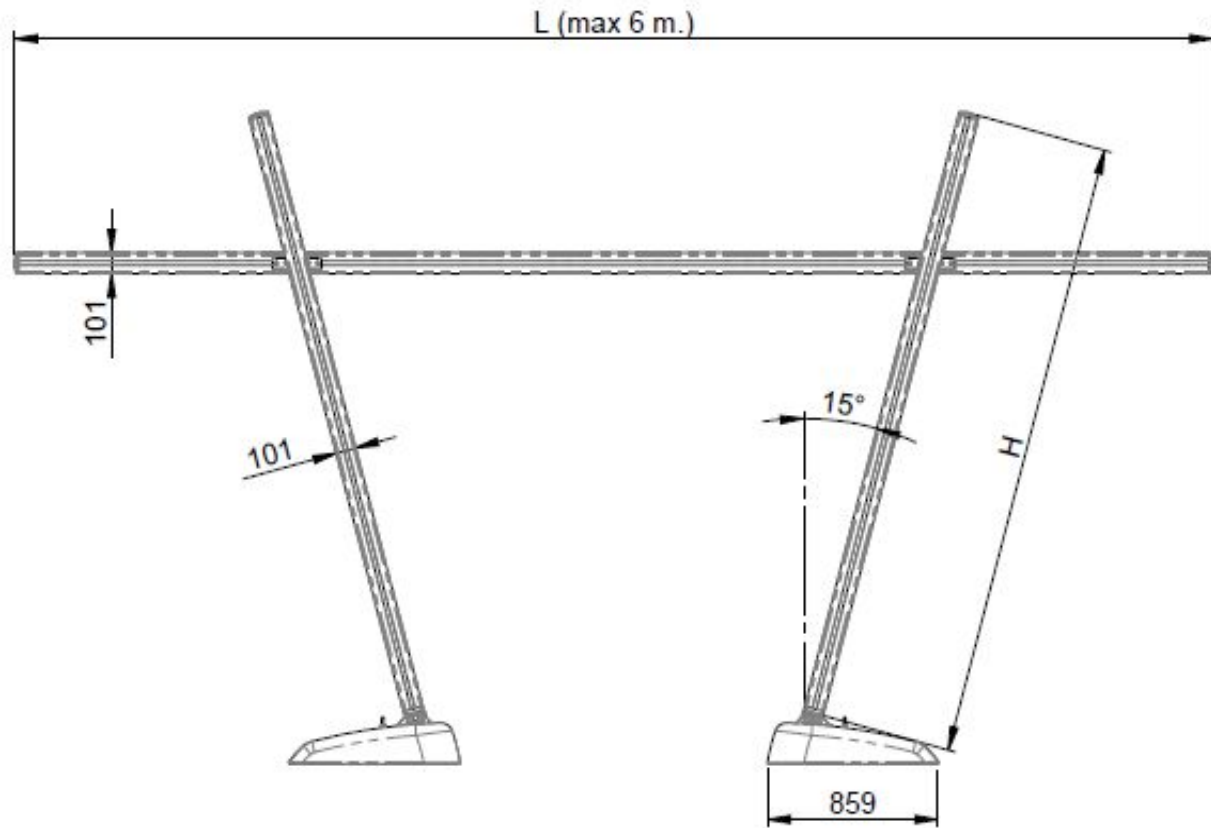
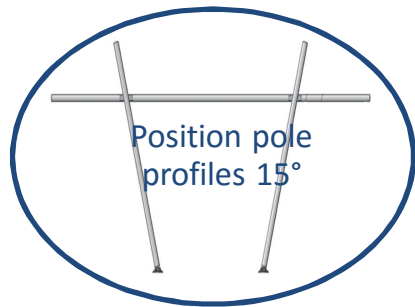

BAMBU

gaviota
Sun Life Specialist

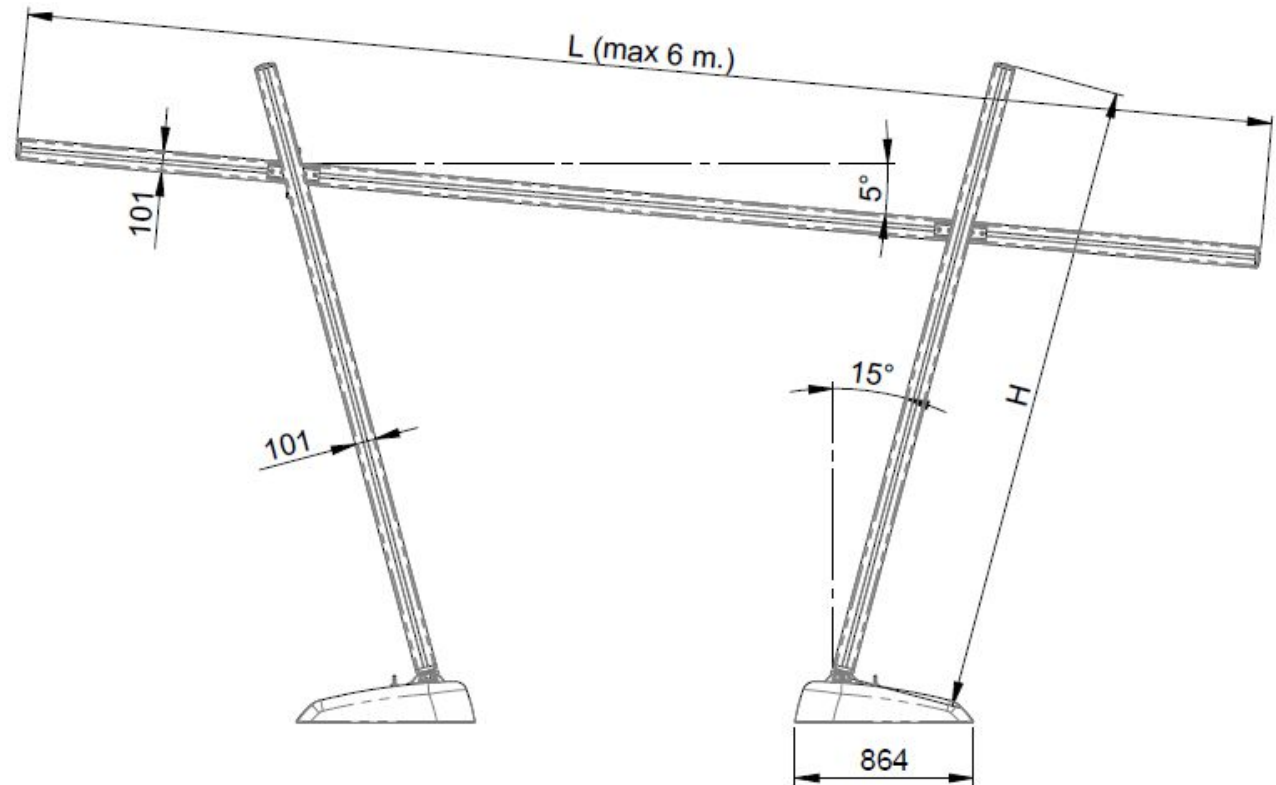
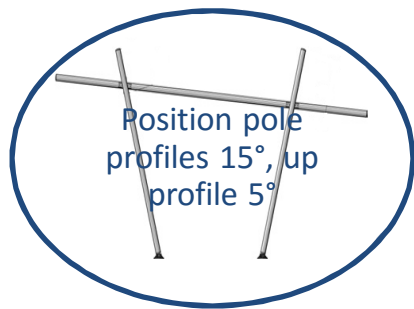

BAMBU

gaviota
Sun Life Specialist

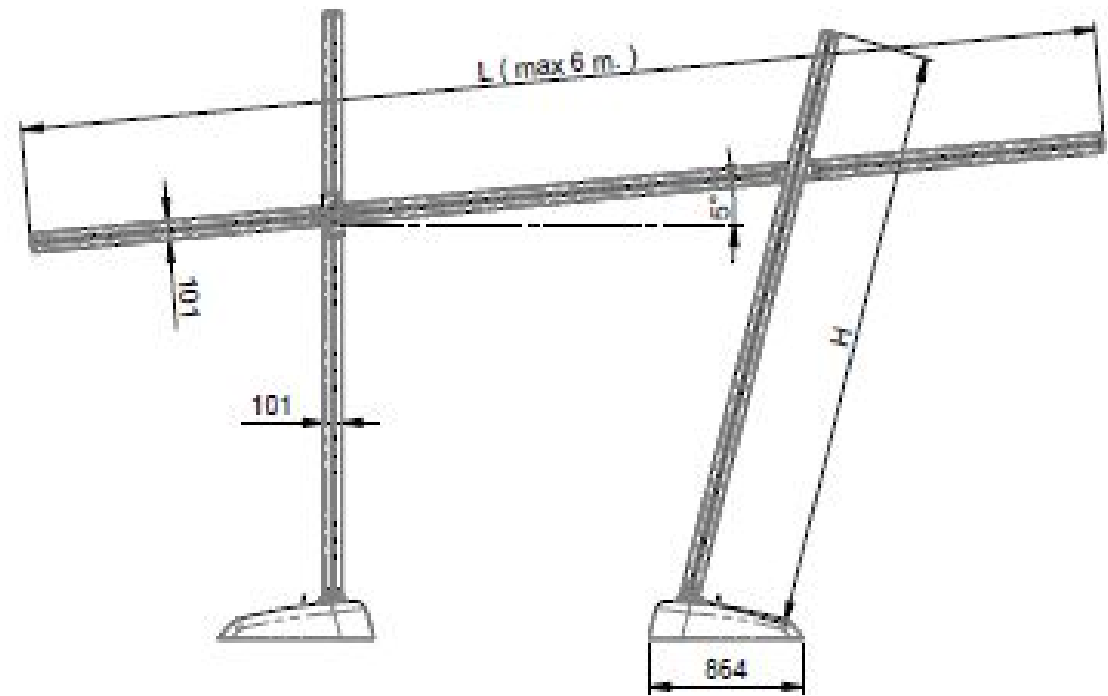
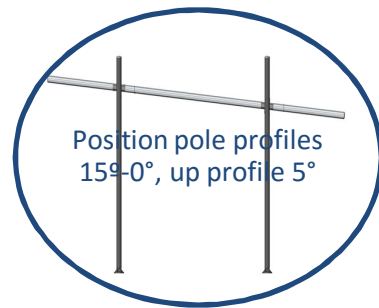

BAMBU

gaviota
Sun Life Specialist

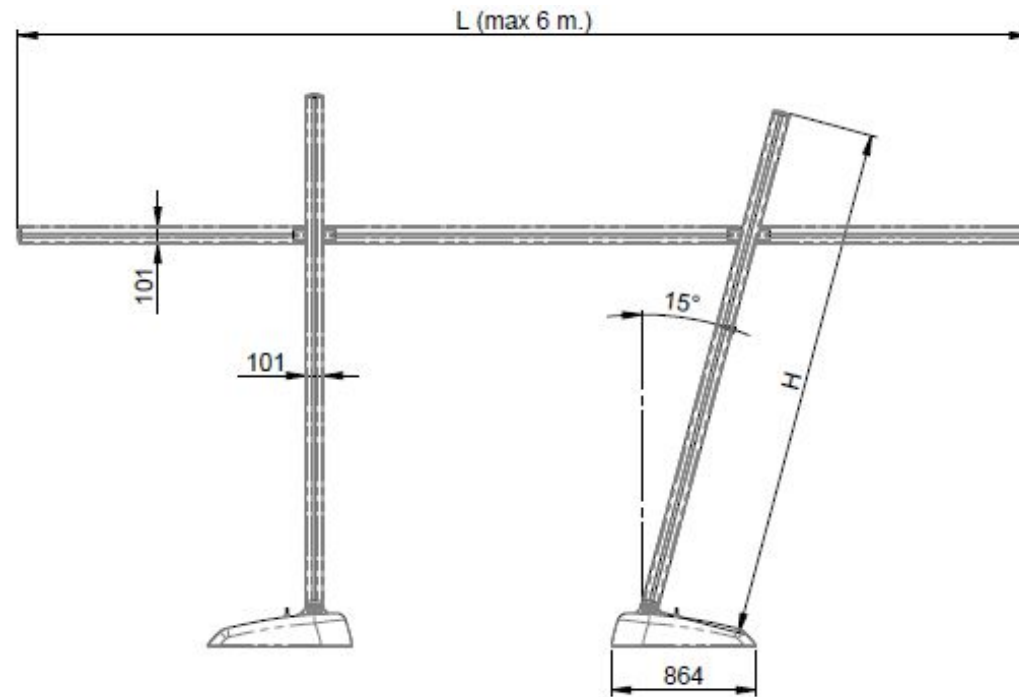
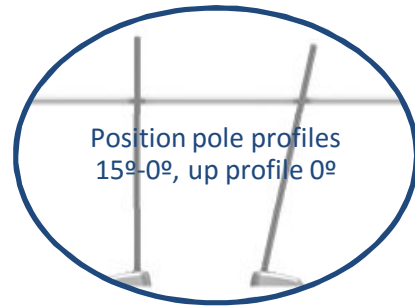

BAMBU

gaviota
Sun Life Specialist

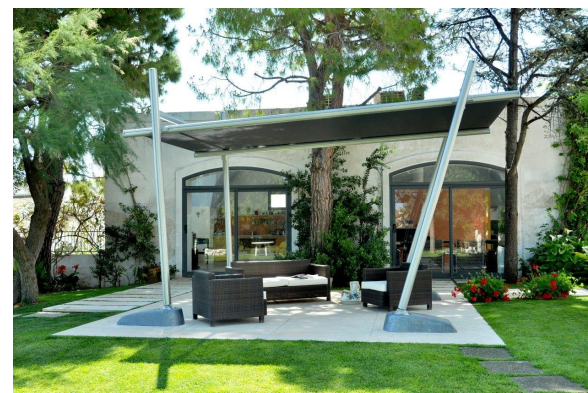

Maximum length up profile A = 6m

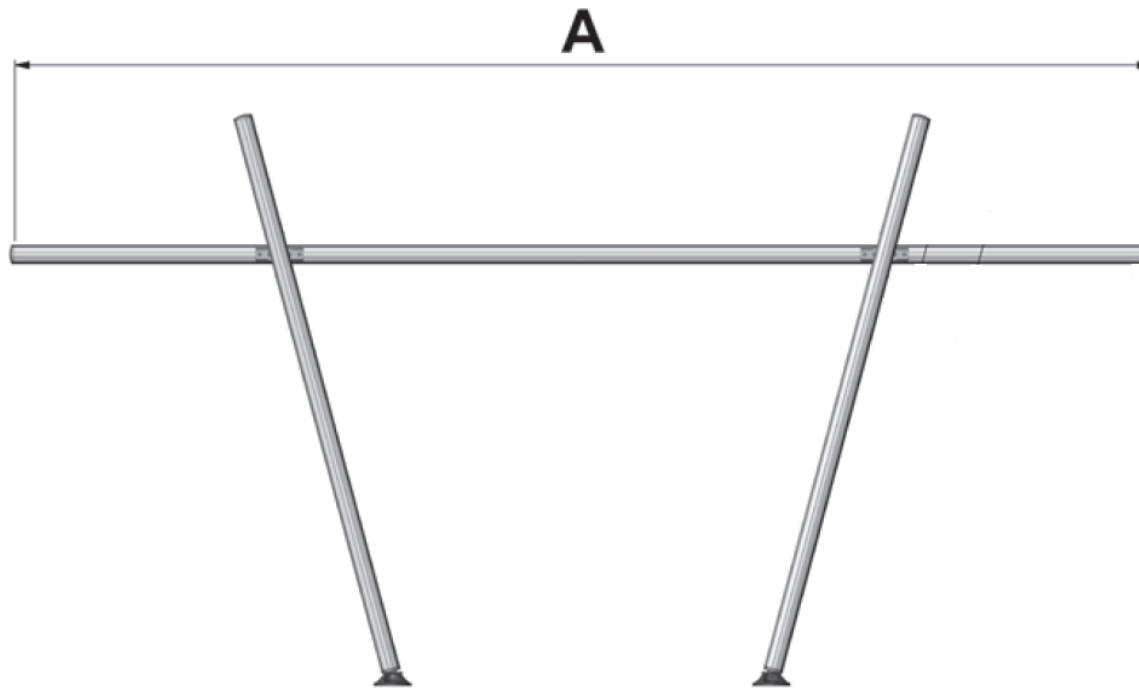

Maximum pole profile length $B = 3\text{m}$

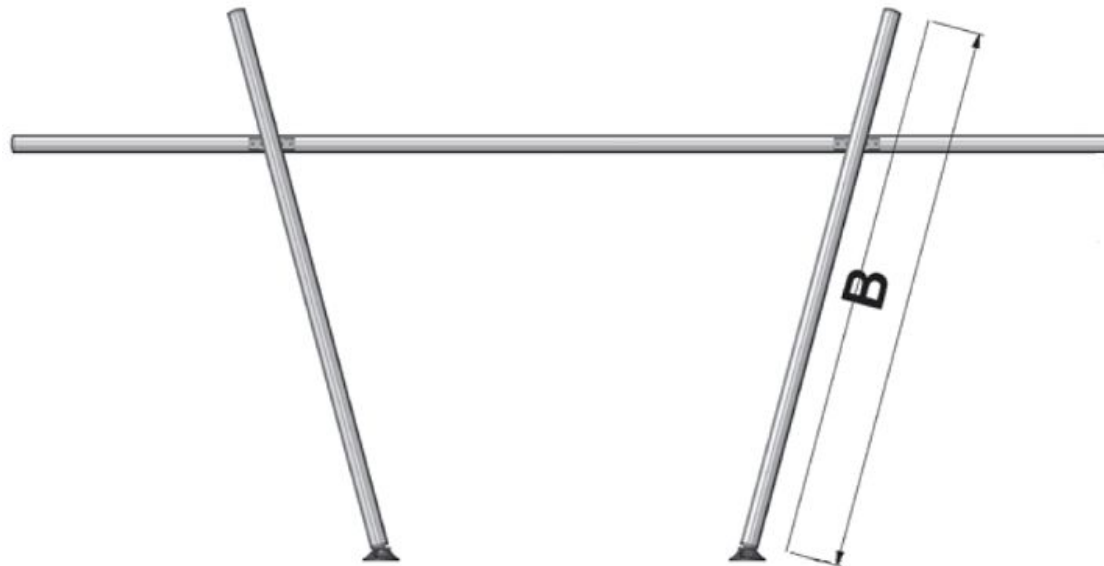

Minimum high to up profile D = 2,1 m



Minimum distance between pole $C = 2$ m

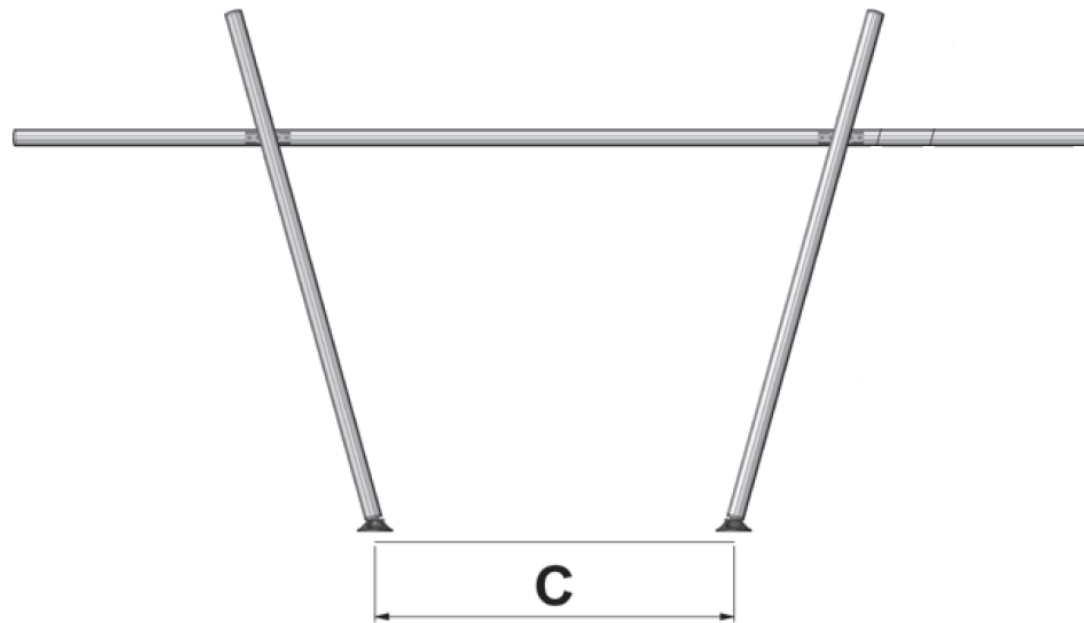

Maximum distance between pole E = 3,282 m

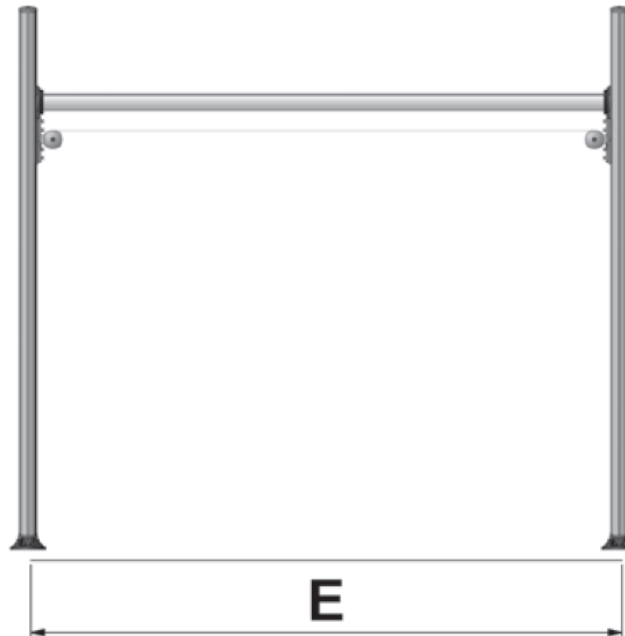

FABRIC

- $L1 = A$
- $L2 = E - 272\text{mm}$

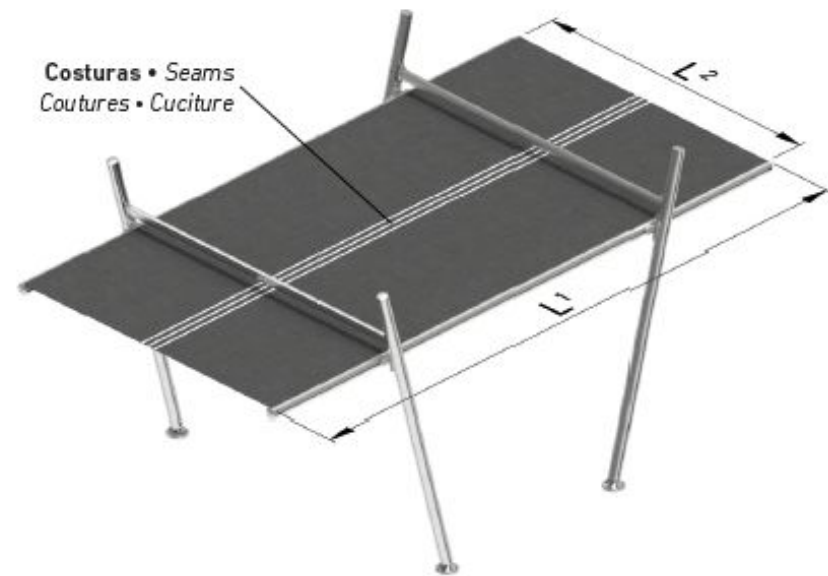
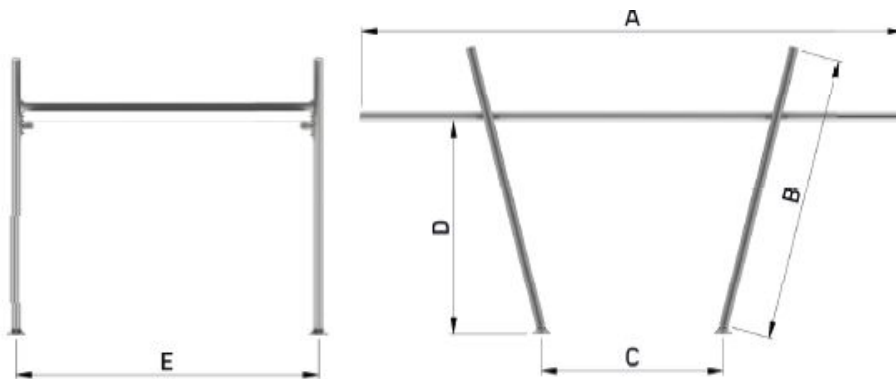

FABRIC RECOMMENDATION:

Polyester

- *2 sides PVC*
- *Drive strength (Warp/Weft): 270 daN - 5 cm / 230 daN - 5 cm*
- *Temperature resistance: -30 +70°*
- *Fire-resistant M2*

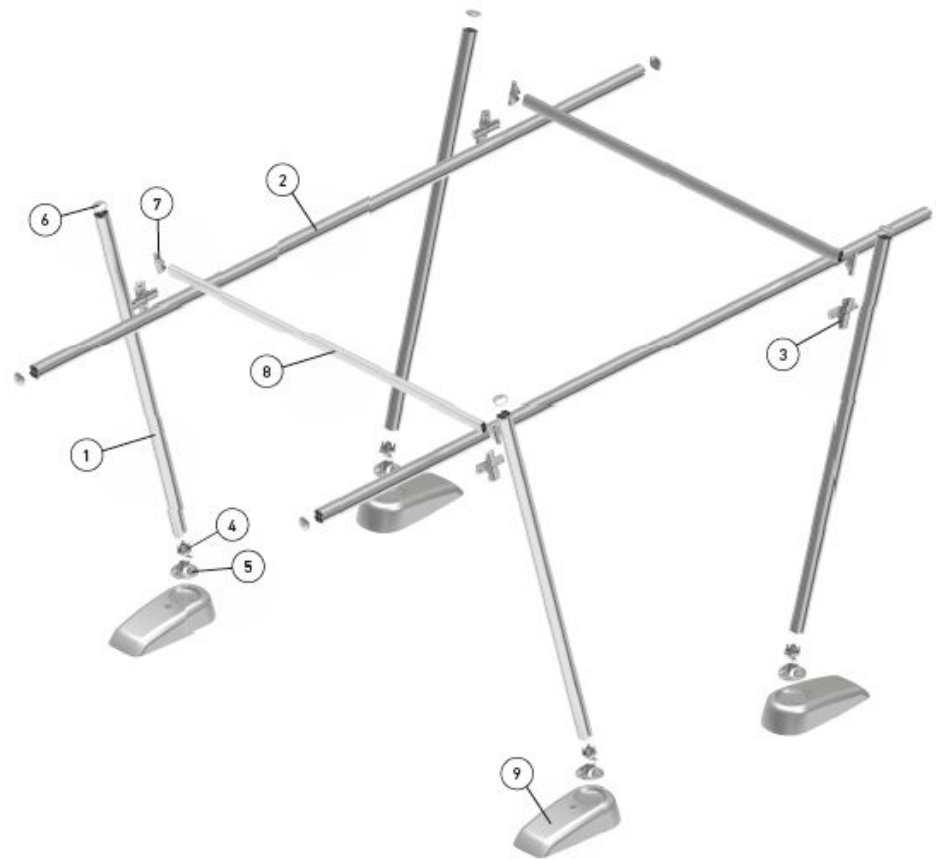

1. Pole profile
2. Up profile
3. Profile joint kit
4. Pole base joint
5. Pole support
6. Pole cap
7. Fabric tension kit
8. Structural profile 90x50
9. Concrete slab

1. Pole profile and 2. Up profile

Weight = 5.556 Kg/m

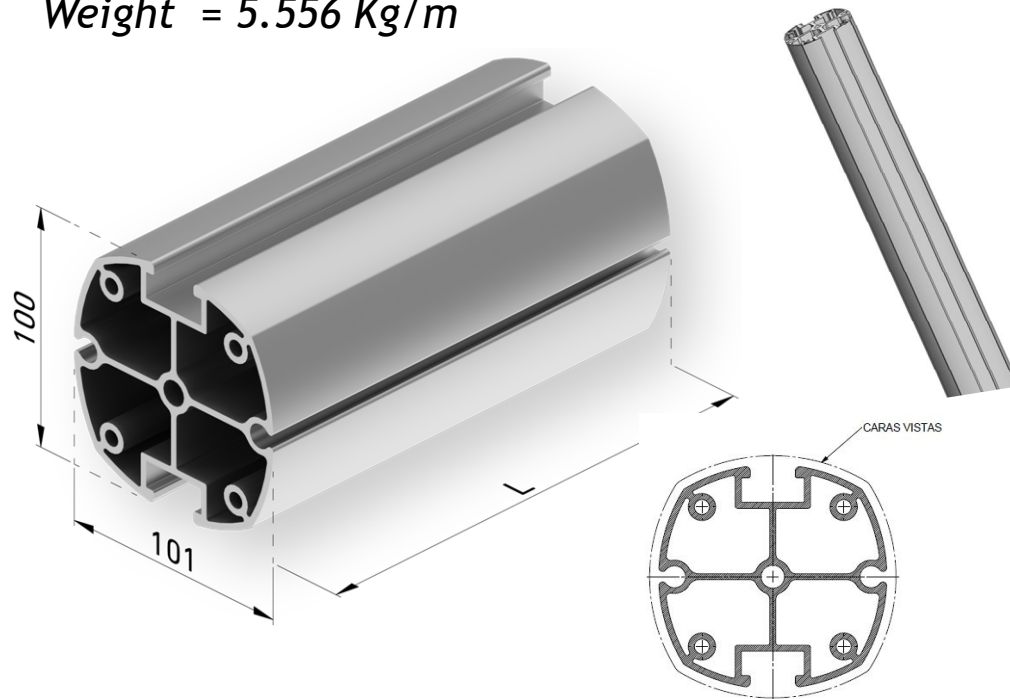

3. Profile joint kit

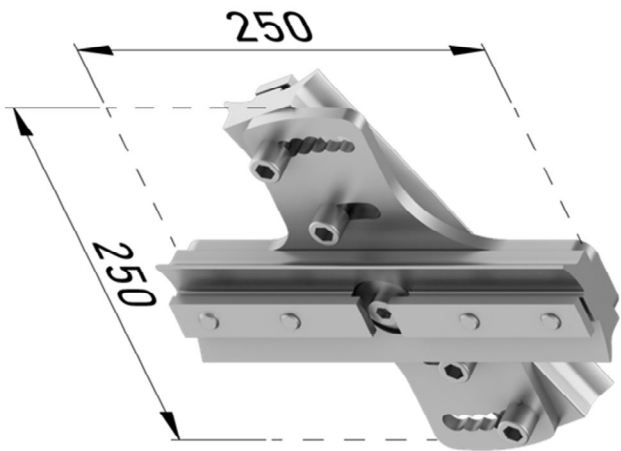

4. Pole base joint

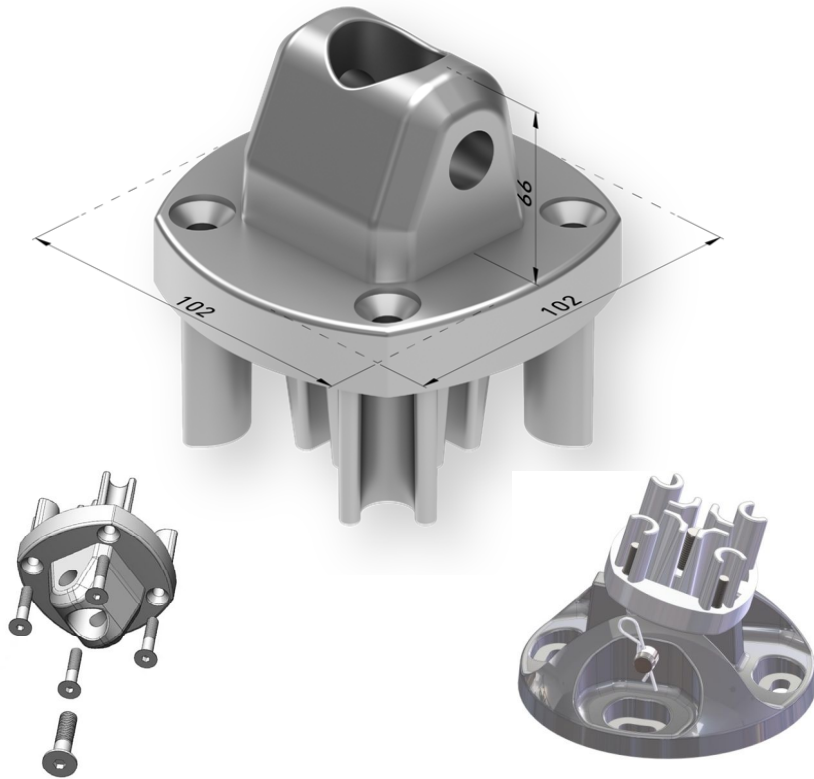

5. Pole support

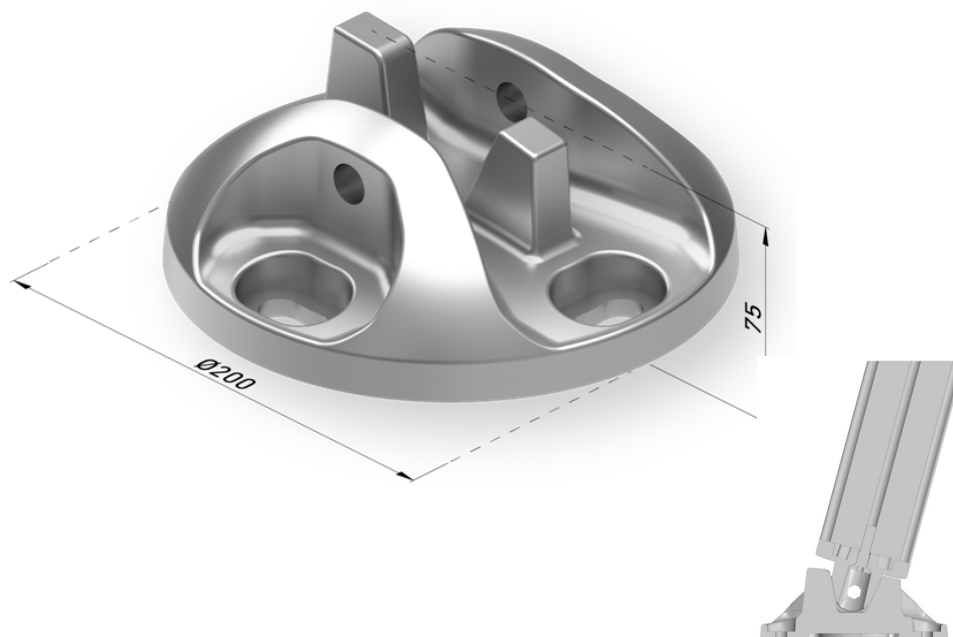

6. Pole cap

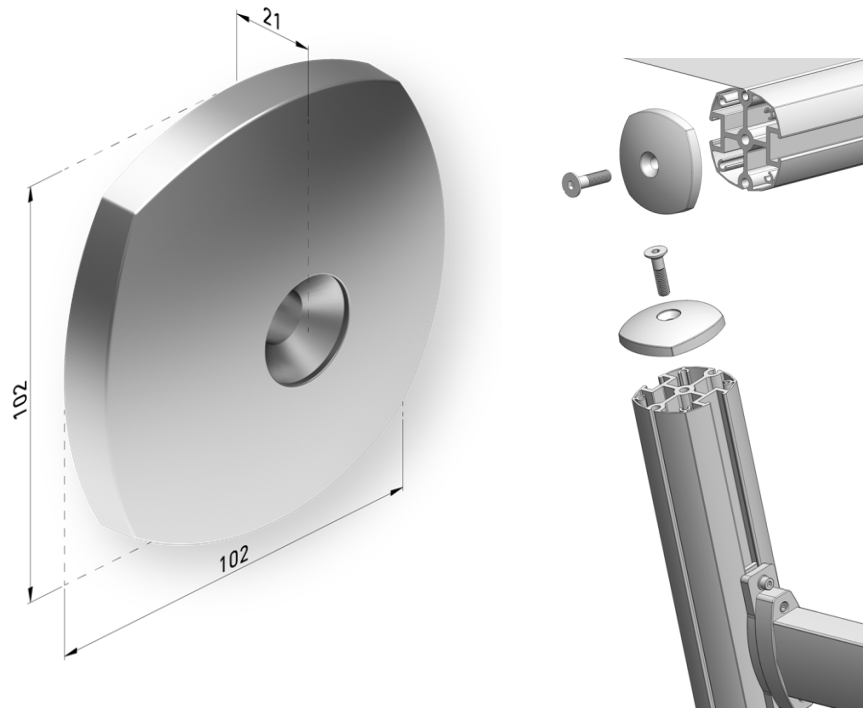

7. *Fabric tension kit*

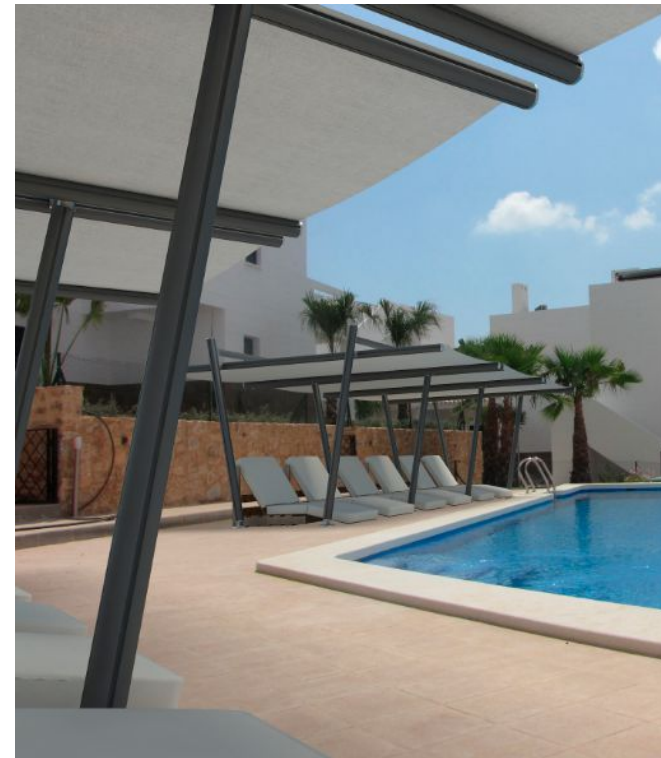
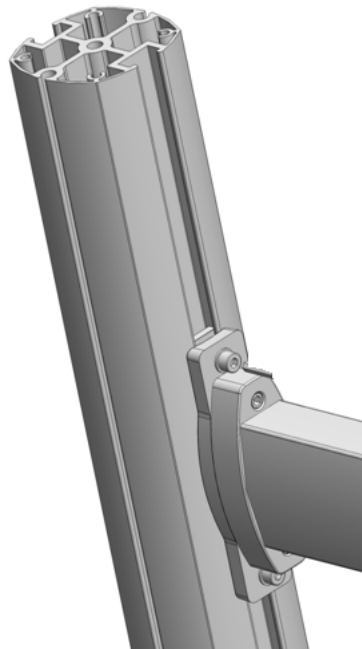
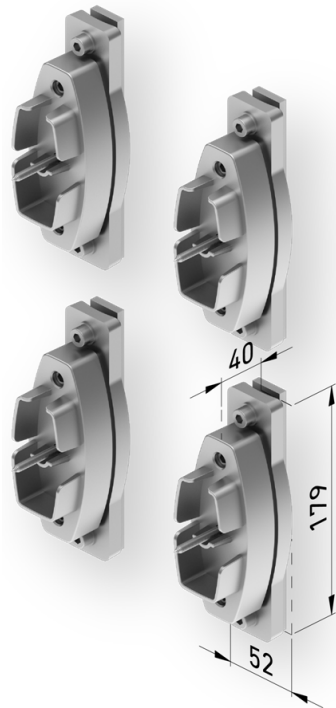

8. *Structural profile 90x50*

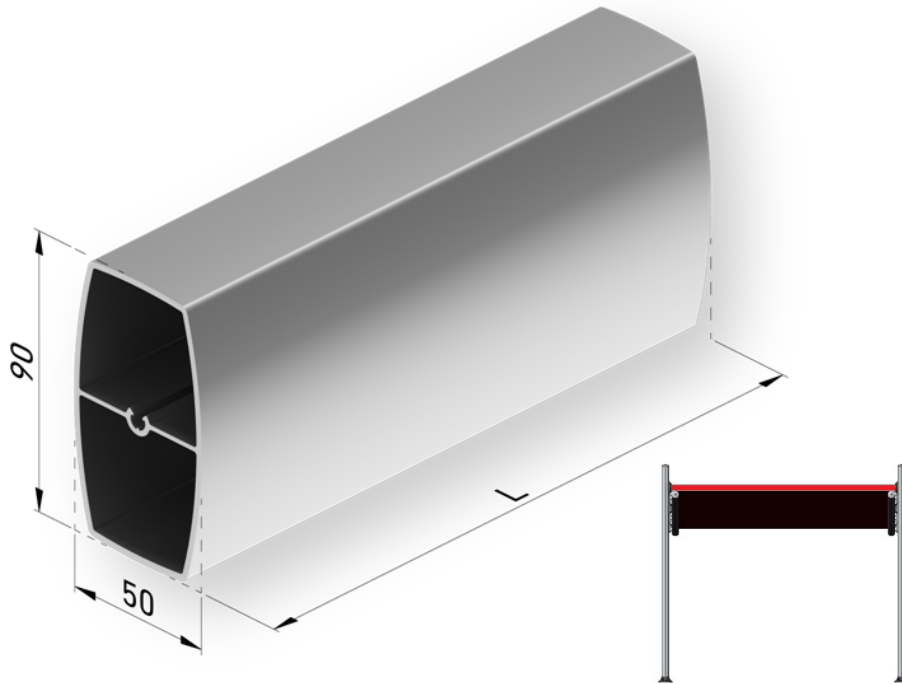

9. Concrete slab

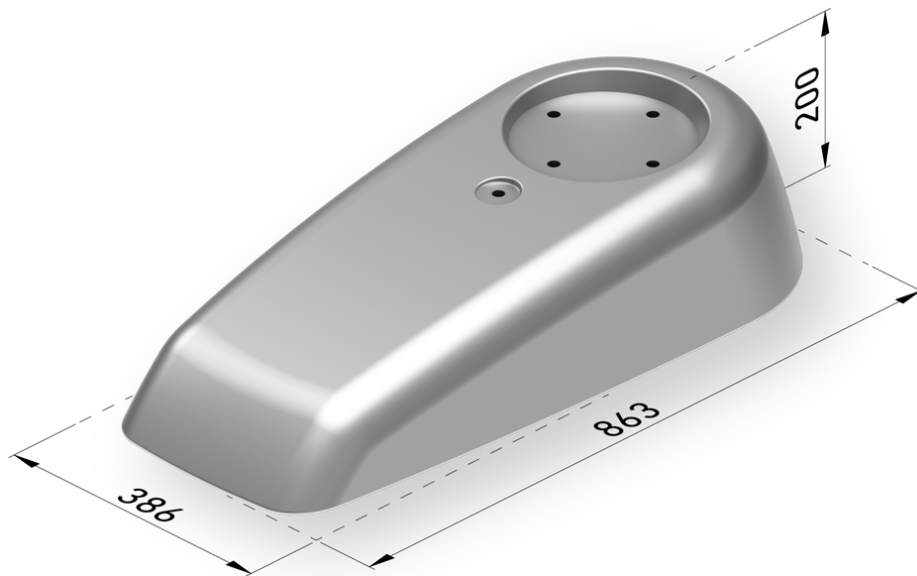

BAMBU

gaviota
Sun Life Specialist

INSTALLATION: part 1 pre-assembling



Thread the holes in the pole and up profiles:

- *Poles: in one side the central hole (M12) and the 4 external ones (M8). On the other side, the central hole (M12)*
- *Up profiles: only the central hole (M12), at both sides*

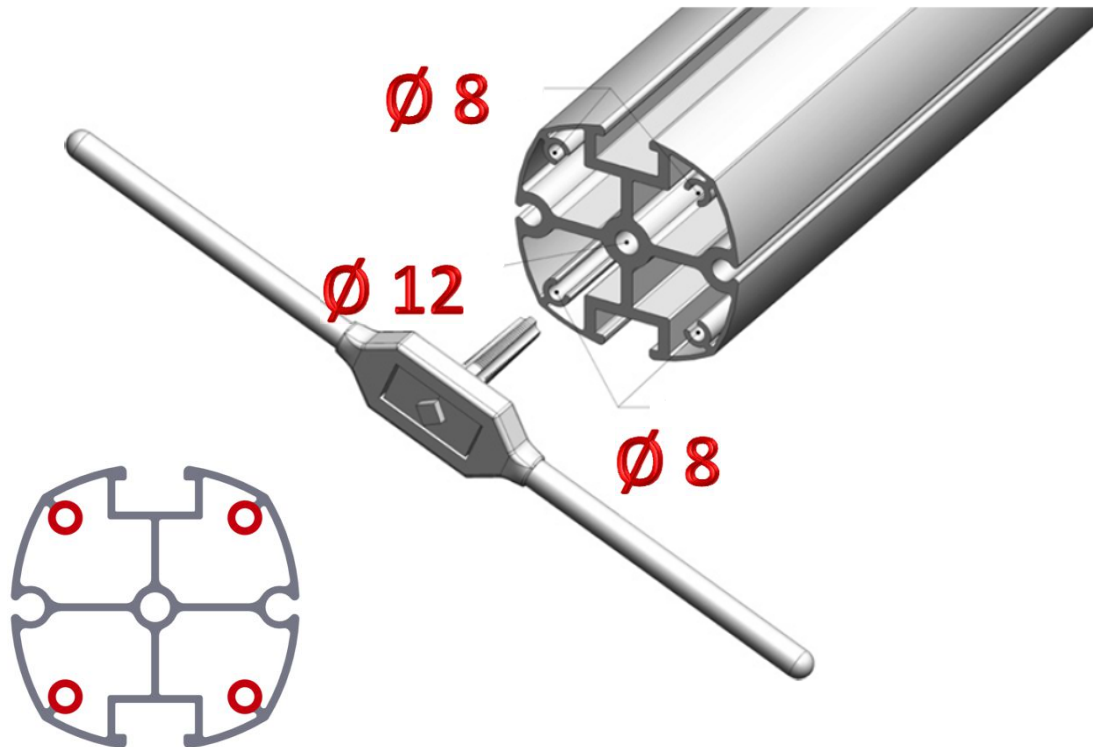

Pole base joint assembly:

- *Place the joint support in the pole profile.*
- *Fix both parts with the provided screws.*

Note: follow this procedure for the four poles.

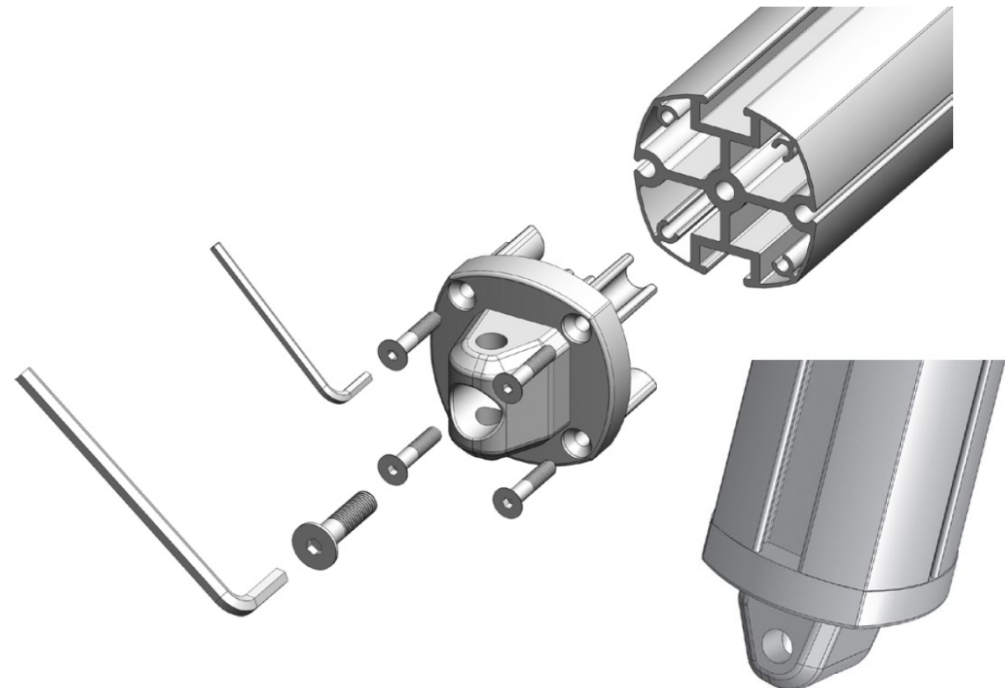

Pre-installing the profile joint kits depending on the chosen assembly option:

- *15°-0° for poles and 5°-0° for up profiles*

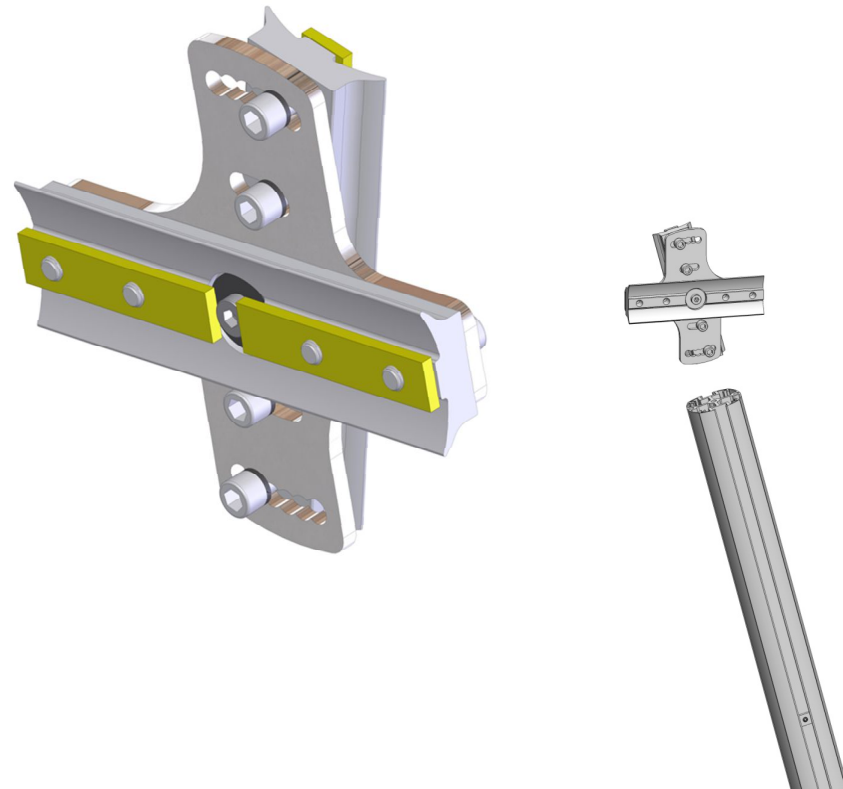

- *Placing the fabric at the up profiles:*
- *Put the flanges as shown at the image.*
- *Place the fabric through the ogives at the upper part of the crossbeam.*

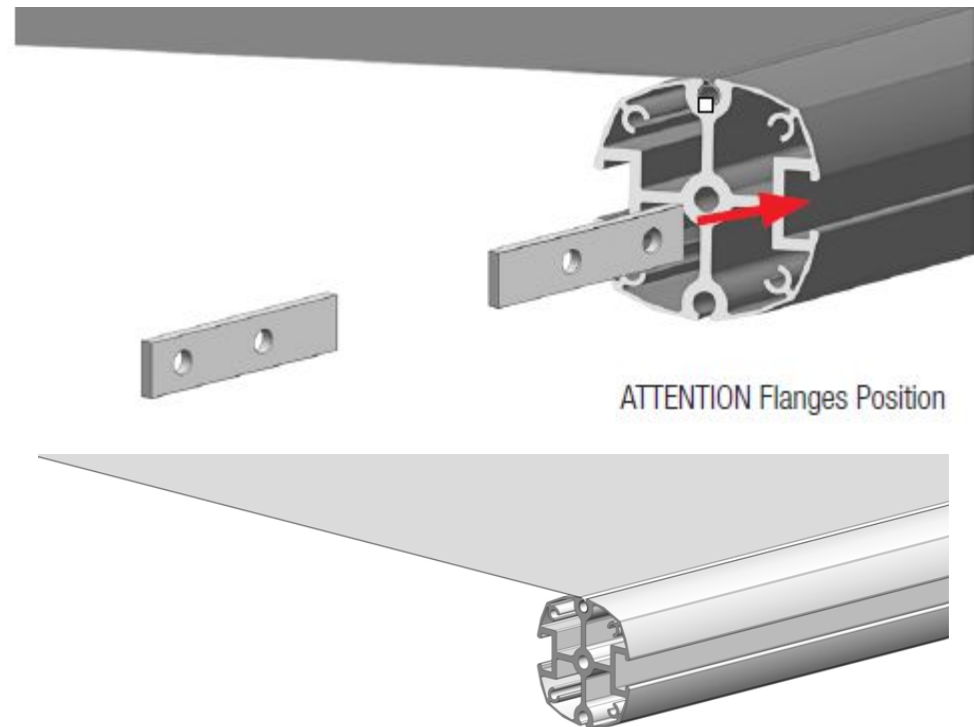

- *Put the caps at the up profiles*
- *Screw down the caps at up profiles*

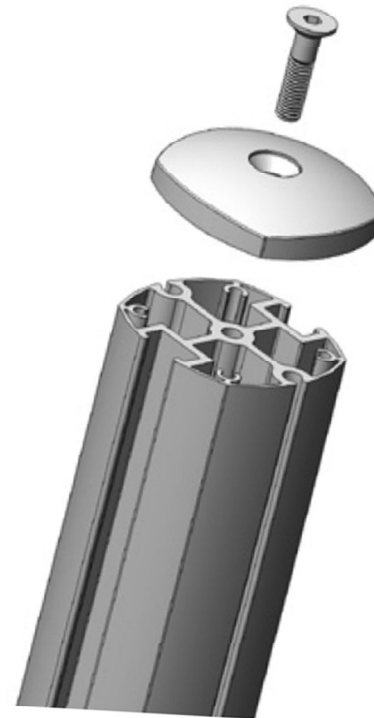

Fabric tensor kit assembly:

- *Coil the prisoners to the piece and align as shown at the image*
- *Put and screw to the profile*
- *Fix the flanges with the screws*

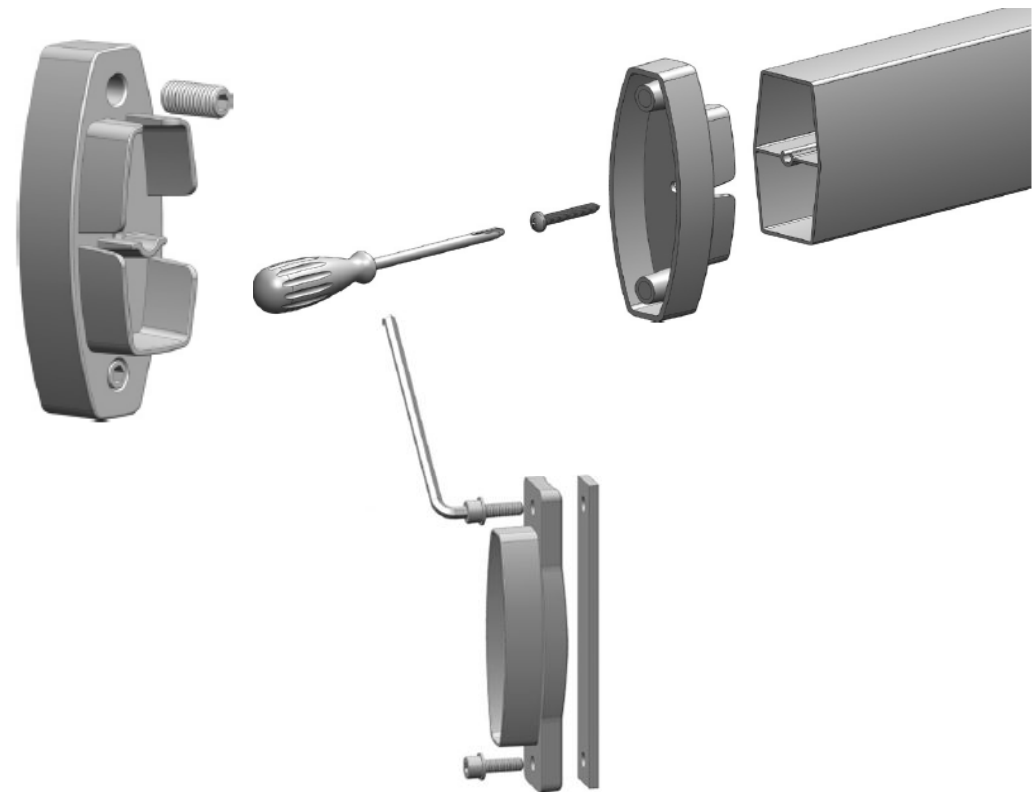

BAMBU

gaviota
Sun Life Specialist

INSTALLATION: part 2 at place



Put the base poles at the right position.

- Check the parallelism of the base poles using diagonal lines
- Drill and fix the base poles to the floor with screws (non included).

M12 recommended.

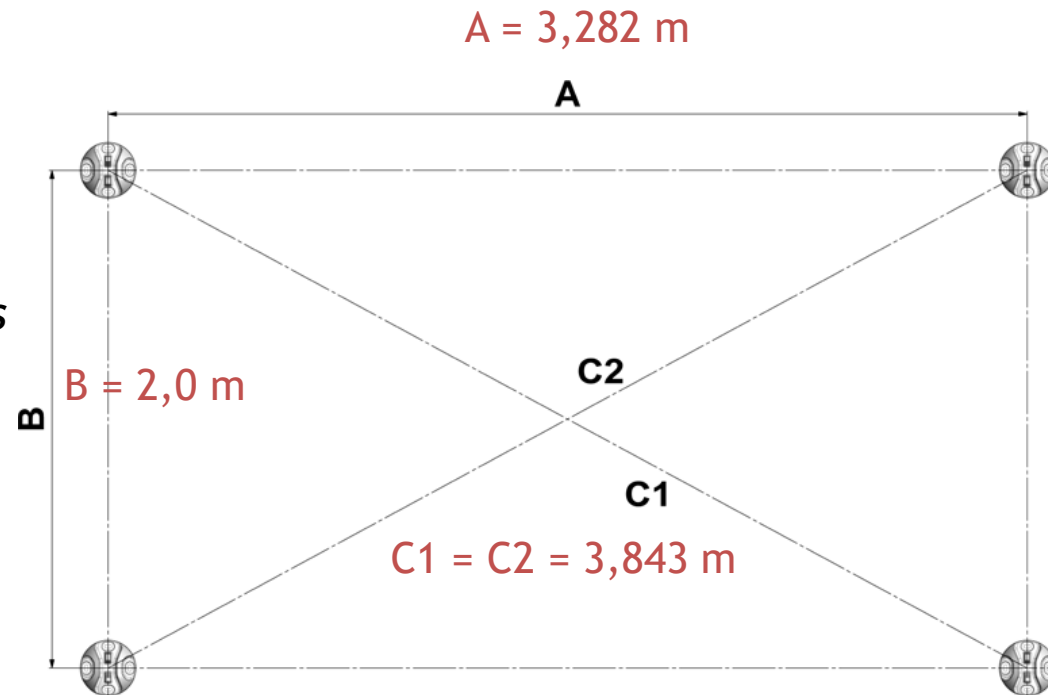
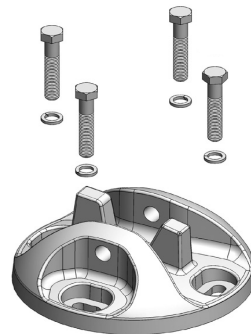

Placing the poles in the base poles:

- *Put the pole in the base pole.*

Note: The poles at the base can be oriented in two positions, 0° and 15°, turning 180° the pole.

- *Insert the bolt and fix it with the safety pin.*

Note: Follow this procedure for the four poles.

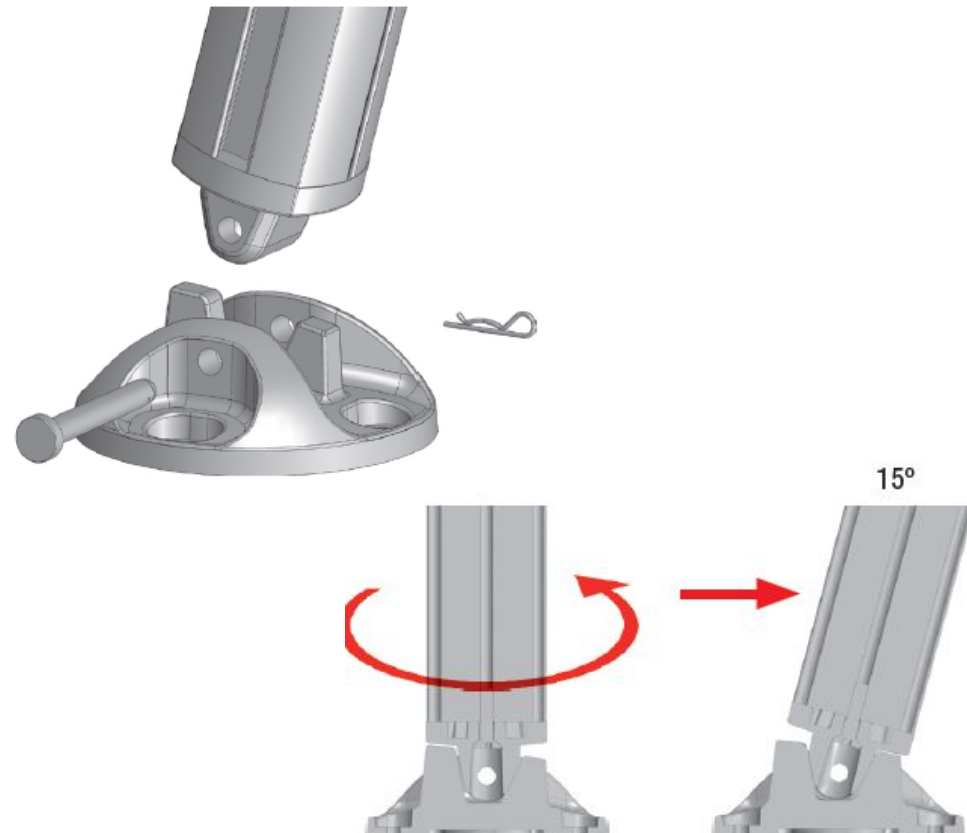

Place the adjustment of the joint knot:

- Introduce it through the profile guide
- Block it to the right distance depending on the chosen assembly option.

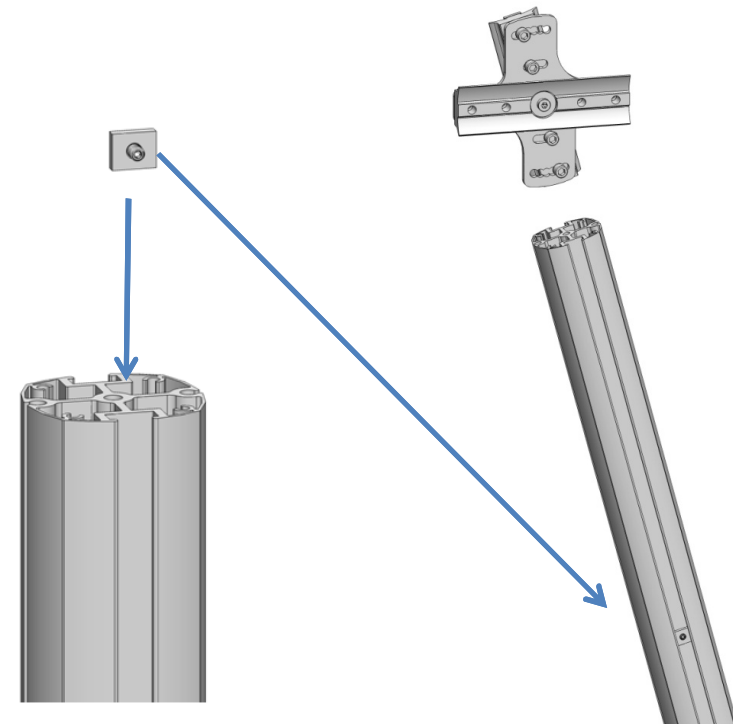

Assembling the knot at the pole:

- *Put the knot through the pole guide to the limit until the assembly flange.*

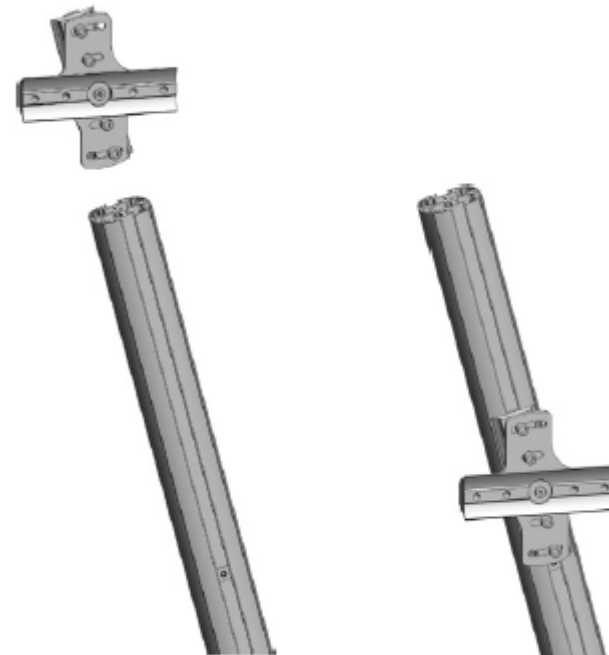

Assembling the up profile at the poles.

- *Bring up the up beams and fix the knot with the screws and the flanges previously placed.*

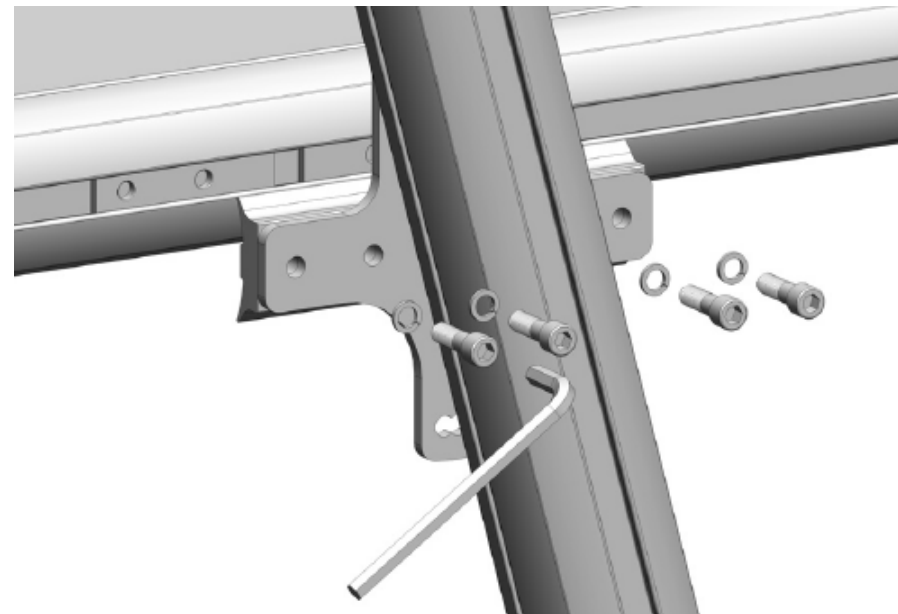

Assembling the up profiles:

- *Put the fixed strut at the mobile one (already placed at the up profiles) and introduce the guide profile until it leans on the pole*
- *Fix to the pole.*
- *Tighten the prisoners until the fabric is taut*

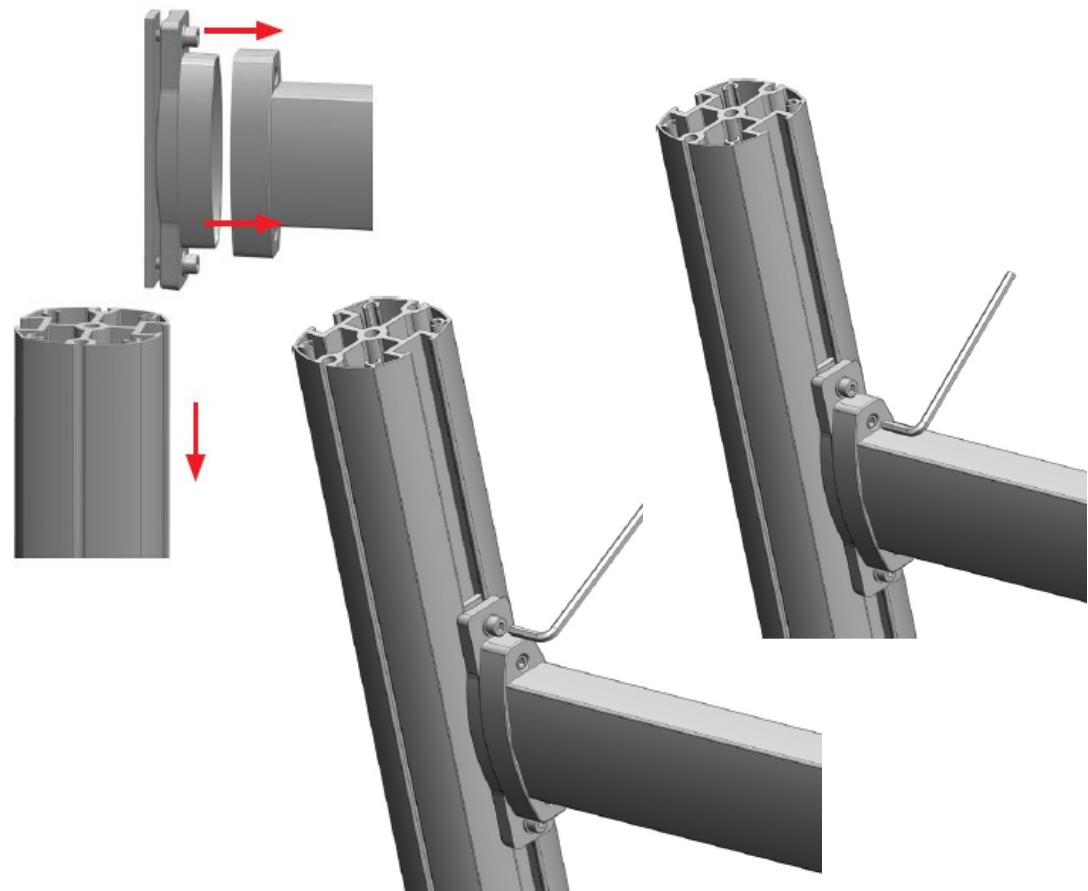

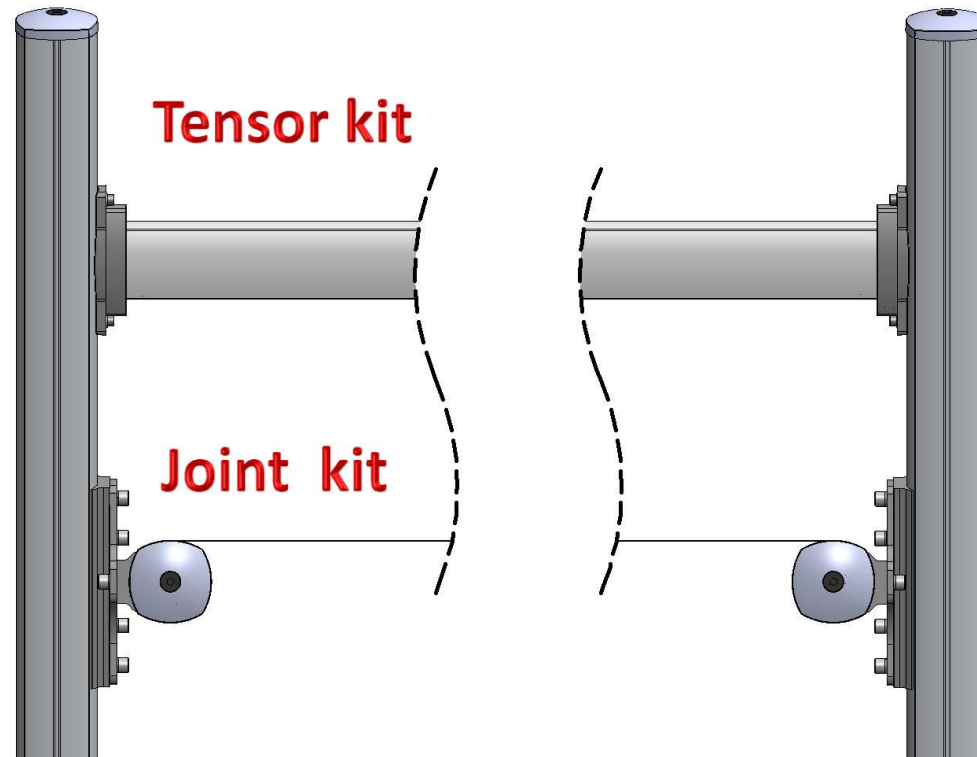

Assembling the pole caps:

- *Place the caps at the upper part of the poles.*



Concrete slabs:

- *It is possible to assemble the Bambu Canvas to the floor whenever is not permitted by law thanks to the use of 100 Kg. reinforced concrete slabs.*



BAMBU

gaviota
Sun Life Specialist

Connected structures:

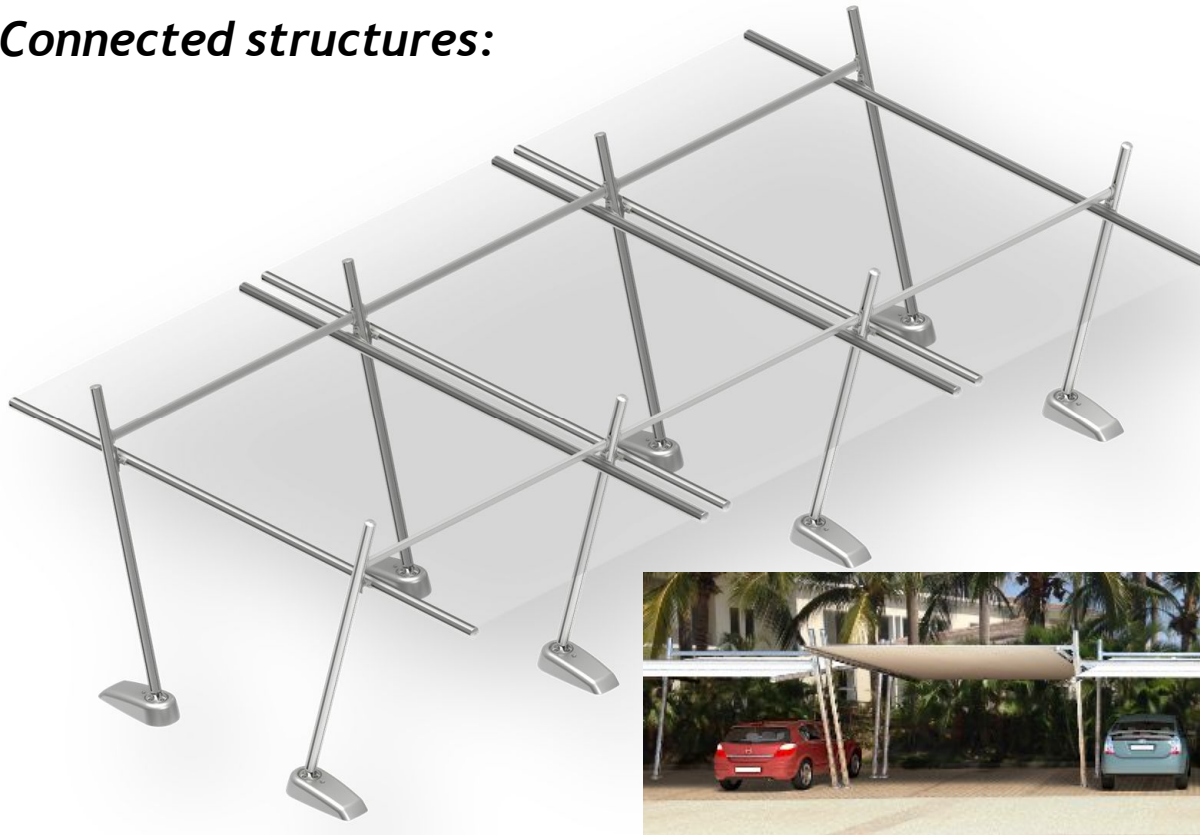



gaviota

Sun Life Specialist